



**313 S. ELM ST.
NORTH PLATTE, NE**

A bungalow style home with 2 bedrooms and 1 bath.

TAMI TIMMERMAN-LASHLEY

Residential Specialist

Tami's Cell: 308-660-9468

Email: tami@lashleyland.com

PROPERTY HIGHLIGHTS

List Price **\$148,000**

Location 313 S. Elm St., North Platte, NE 69101

Legal Description

LOT 12, , PATRICIA'S SUBDIVISION TO NORTH PLATTE, LINCOLN COUNTY, NEBRASKA.

Taxes - Estimated **\$1,496.40**

Property Summary

Welcome to this charming 1950s bungalow featuring two bedrooms and one bathroom, ideal as a starter home or move in ready investment property. The layout includes a spacious kitchen, and the included washer and dryer add to your convenience. The updated bathroom has a nice sized vanity. The partially fenced backyard offers potential for a future garage or could be fully fenced very inexpensively. Step outside to enjoy the patio, perfect for entertaining guests or relaxing. With newer windows throughout and a prime location near shopping, schools, and restaurants in both downtown North Platte and the Westfield Shopping Center, this delightful home combines comfort and convenience.

All information is taken from the Lincoln County assessor's card and it is no way a guarantee or warranty.

All information herein is from sources deemed reliable, however the accuracy is not guaranteed by Lashley Land and Recreational Brokers, Inc., seller or agent. Offering is subject to error, omissions, prior sale, price change or withdrawal without notice.

TAMI TIMMERMAN-LASHLEY

Residential Specialist

Tami's Cell: 308-660-9468

Email: tami@lashleyland.com

LOCATION MAP

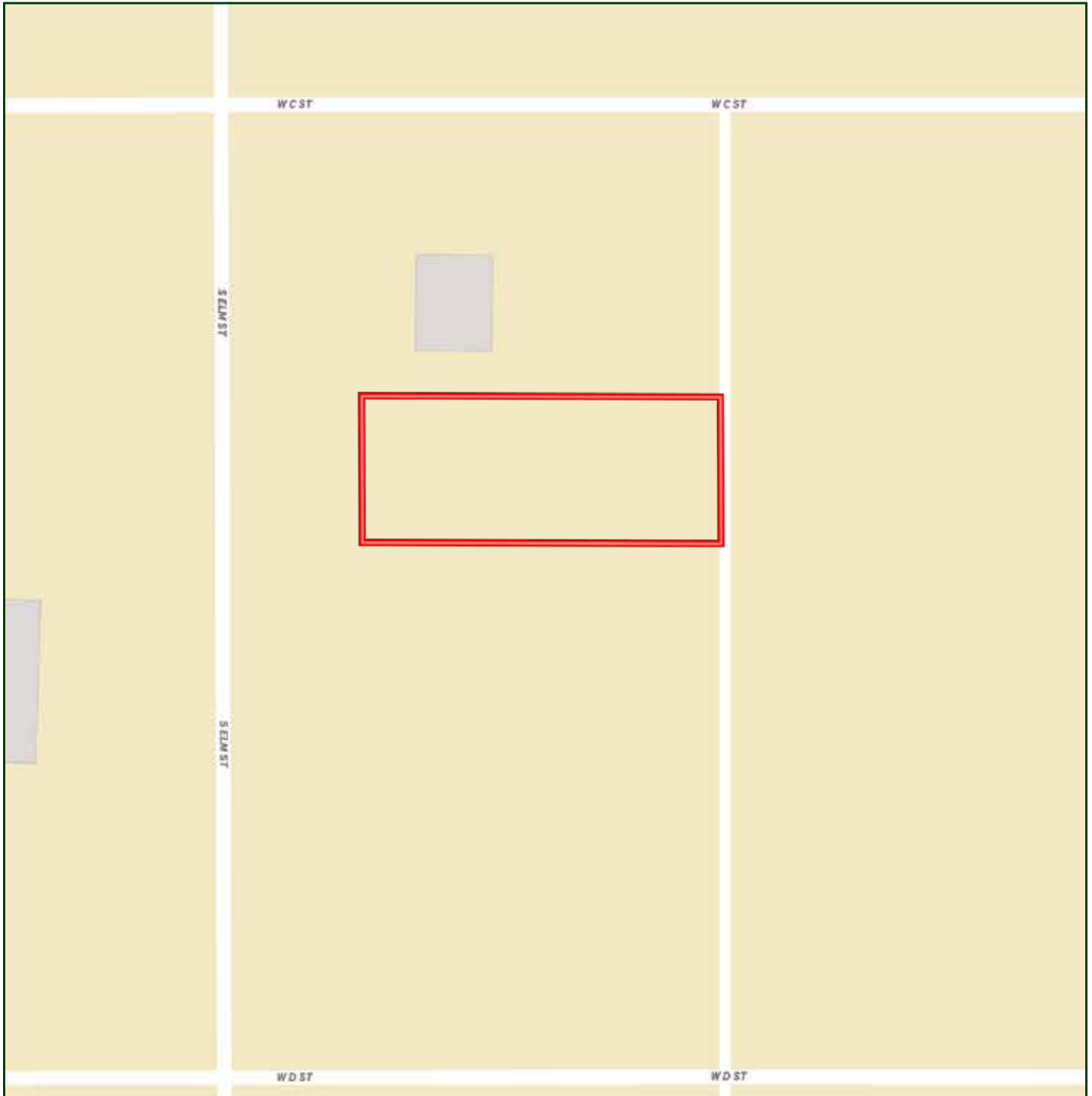

Boundary lines are estimates - Map for illustration only

AERIAL MAP



Boundary lines are estimates - Map for illustration only

TAMI TIMMERMAN-LASHLEY

Residential Specialist

Tami's Cell: 308-660-9468

Email: tami@lashleyland.com

PROPERTY IMAGES



PROPERTY IMAGES



TAMI TIMMERMAN-LASHLEY

Residential Specialist

Tami's Cell: 308-660-9468

Email: tami@lashleyland.com

PROPERTY IMAGES





NEBRASKA EXPERTS, NATIONAL EXPOSURE.

Contact Information

Office: 308-532-9300

Fax: 308-532-1854

Email: info@lashleyland.com

Website: LashleyLand.com

Mike Lashley, Owner | Broker

Amy Lashley-Johnston, Scott Saults, Skip Marland, Jordan Maassen, April Good, Jon Farley, Tami Timmerman-Lashley, Randy Helms, Bill Grant, Shane Mauch, Jake McQuillen, Brandi Housman, Leala Jimerson, Stephanie Miller, DeAnn Vaughn, Ann Gray, Jake Hopwood, Bryan Cabrera, Lindsey Feuerborn, Robby Uehran, and Tom Moss

Like us on Facebook
[Facebook.com/LashleyLand](https://www.facebook.com/LashleyLand)

2218 E. Walker Road • North Platte, NE 69101



TAMI TIMMERMAN-LASHLEY

Residential Specialist

Tami's Cell: 308-660-9468

Email: tami@lashleyland.com